

Why A4 Copier?

In the past customers always considered they needed an A3 Copier. However, according to a recent report*, just 2.35% of the total page volume printed is on A3 paper. Given that the average office worker produces 8,636 pages a year, just 202 pages are A3, which is less than a page a day. Because people are moving towards scanning and printing original documents, which can be scaled to fit the paper size available, the need for A3 output has declined. In addition, a few years ago there was no software such as Microsoft Office, Acrobat Reader and several types of Internet Browsers. Just think. When is the last time you copied or printed on an A3 Copier?

Office space is also a big issue. In general, A3 centric copiers occupy more office space. Typically, the footprint of a mono A3 capable device is much larger than that of an A4 device, 70%* larger by volume on average. An A3 device takes up a lot of space with its console. But an A4 device only needs the corner of your desk or room.

In terms of TCO then generally, the A3 copier is more expensive to purchase and maintain than an A4 MFP. The premium is between 100% and 220%* depending on the manufacturer. Also the cost of a maintenance kit for an A3 copier is 26%* higher than that of an A4.

Finally, an A3 capable MFP device consumes more operating power and cost as the fuser unit is 41% larger.

It doesn't matter if an A4 page is being printed or an A3 page because the whole fuser unit is heated up.

*Source : UK Research Study 2006 "NewField IT" Report



Specifications

MultiXpress 6345N	
Print	
Method	2 Beam Laser Scanning Unit and Electro Photography
Speed *	Up to 43 ppm in A4 (45 ppm in Letter) Duplex Printing Speed : Up to 40 ipm in A4 (42 ipm in Letter)
Resolution	Up to 1,200 x 1,200 dpi Effective Output
First Print Out Time	8 seconds (from Standby mode)
Emulation	PCL6, PostScript 3
Memory	256 MB (Shared)
Duplex Print	Standard
Copy	
Speed **	Up to 43 cpm in A4 (45 cpm in Letter)
Resolution (Optical)	•Scan : up to 600 x 300 (text, text/photo) up to 600 x 600 (photo using platen) up to 600 x 300 (photo using DADF) •Print : up to 600 x 600 (text, text/photo, photo)
Resolution (Enhanced)	>
First Copy Out Time	Less than 5 seconds
Zoom Rate	25 ~ 400 % (platen), 25 ~ 200 % (ADF)
multi Copy	1-999
Duplex Copy	Standard (1:2, 2:2, 2:1)
Scan	
Compatibility	Twain standard, WIA standard
Method	Colour CCD
Resolution (Optical)	600 x 600 dpi
Resolution (Enhanced)	Max. 4,800 x 4,800 dpi
Scan to	E-mail, FTP, SMB, Client
Effective Scan Length	•Platen : 348 mm •DADF : 348 mm
Effective Scan Width	Max 208 mm (8.2")
Colour Bit Depth	•Internal : 36 bit •External : 24 bit
B/W Bit Depth	1 bit for Text mode, 8 bit for Gray mode
Gray Scale	256 Levels
Fax	
Compatibility	ITU-T G3, Super G3
Applicable line	PSTN / PABX
Modem Speed	33.6 Kbps
Transmission Speed ***	Approx. 3 seconds per page
Compression Mode	MH / MR / MMR / JBIG / JPEG
Scan Speed ****	Platen : Approx. 2 sec ADF : Approx. 5.5 sec
Resolution	•Standard : 203 X 98 dpi •Fine : 203 X 196 dpi •Super Fine : 203 X 391dpi, 300 X 300 dpi, 406 X 392 dpi
Memory	16 MB
Auto Dial	Speed dial : 200 Locations
Paper Handling	
Input Capacity and Types	•Main Tray : Up to 520 sheets (75 g/m ²) •MP Tray : 100 sheets
Output Capacity and Types	500-sheet Face Down (75 g/m ² , 20 lbs)
Media Size (for Print)	Letter, Legal, Oficio, Folio, A4, JIS B5, ISO B5, Executive, A5, Statement, A6, PostCard 4x6, Envelope B5, Envelope Monarch, Envelope COM-10, Envelope DL, Envelope C5, Envelope C6, Custom
Media Size (for Fax and Copy)	for Fax : Letter, A4, Legal
Media Type	Plain Paper, Thin Paper, Bond, Punched, Pre-Printed, Recycled, Envelope, Transparency, Label, CardStock, Postcard, Letterhead, Thick, Cotton, Coloured, Archive
ADF Capacity	DADF 50 sheets (20 lb, 75 g/m ² , 0.1 mm)
ADF Document Size	•Width : 174 ~ 218 mm (6.9"-8.5") •Length : 128 ~ 356 mm (5" ~ 14.0") for Single page scan 128 ~ 400 mm (5" ~ 15.7") for Multi pages scan
General	
Net Dimension (W x D x H)	637.4 X 489 X 616 mm
Packing Dimension (W x D x H)	822 X 600 X 713 mm
Weight with Consumables	44.5 kg
Packing Weight	51 kg
LCD	1/2 VGA (640 x 240)
System Memory	256 MB
Internal HDD	40 GB
Interface	Hi-Speed USB 2.0, Ethernet 10/100 base TX
OS Compatibility *****	Windows Me/2000/XP(32/64bit)/2003 Server(32/64bit)/Vista, Various Linux OS including Red Hat 8-9, Fedora Core 1-4, Mandrake 9.2-10.1 and SuSE 8.2-9.2 Mac OS 10.3-10.4, Citrix Presentation Server, SAP, Windows Terminal Services
Warm-up Time	Less than 35 sec from sleep mode
Noise Level *****	•Operating : 60 dBA @ simplex printing, 62 dBA @ simplex copy •Standby : 43 dBA AC 110 ~ 127V (-10%-6%) / 6A AC 220 ~ 240V (-10%-6%) / 3A (Not convertible) 50 / 60 Hz
Power Requirement	
Power Consumption	•Sleep Mode : 35 W •Standby Mode : 170 W •Average : 900 W
Operating Conditions	•Temperature : 10 ~ 32° •Humidity : 20 ~ 80% RH
Duty Cycle, Monthly	Up to 200,000 pages
Warranty	One Year On-Site Warranty, Samsung Total Satisfaction Guarantee

Supplies & Options

Consumables											
Type	2-piece Cartridge										
Yield	•Toner : Average Cartridge Yield 20,000 standard pages. Declared yield value in accordance with ISO/IEC 19752 •Drum : 60,000 Pages *****										
Code	•Toner : SCX-D6345A •Drum : SCX-R6345A										
Options											
Network	Standard										
Others	•Fax Kit Serial Type : SCX-FAX100 •Fax Kit Parallel Type : SCX-FAX101 •Finisher : SCX-FIN11S •Staple Cartridge : SCX-STP000 •Stand Short Type : SCX-DSK10S •Stand Tall Type : SCX-DSK10T •FDI Kit : SCX-KIT10F •Optional 520 sheet CST : SCX-S6345A										
SCX-D6345A	SCX-R6345A	SCX-FAX100	SCX-FAX101	SCX-KIT11S	SCX-FIN10S	SCX-STP000	SCX-DSK10S	SCX-DSK10T	SCX-KIT10F	SCX-S6345A	ML-MEM140
Toner	Drum	Fax Kit Serial	Fax Kit Parallel	Smarter™ Workflow	Finisher	Staple Cartridge	Stand Short	Stand Tall	FDI Kit	Optional 520 sheet CST	256 MB Memory

* Print speed will be affected by Operating system used, computing performance, application software, connecting method, media type, media size and job complexity. ** Copy Speed is based on Single Document Multiple Copy
*** Condition : Standard resolution, MMR/JBIG. Maximum modem speed, Phase C by ITU-T No.1 Chart, Memory Tx, ECM **** Condition : ITU-T No.1 Chart, Standard Resolution
***** Please visit www.samsungprinter.com to download the latest software version. ***** Sound Pressure Level, ISO7779 ***** May be affected by operating environment, printing interval, media type and media size

Distributed by

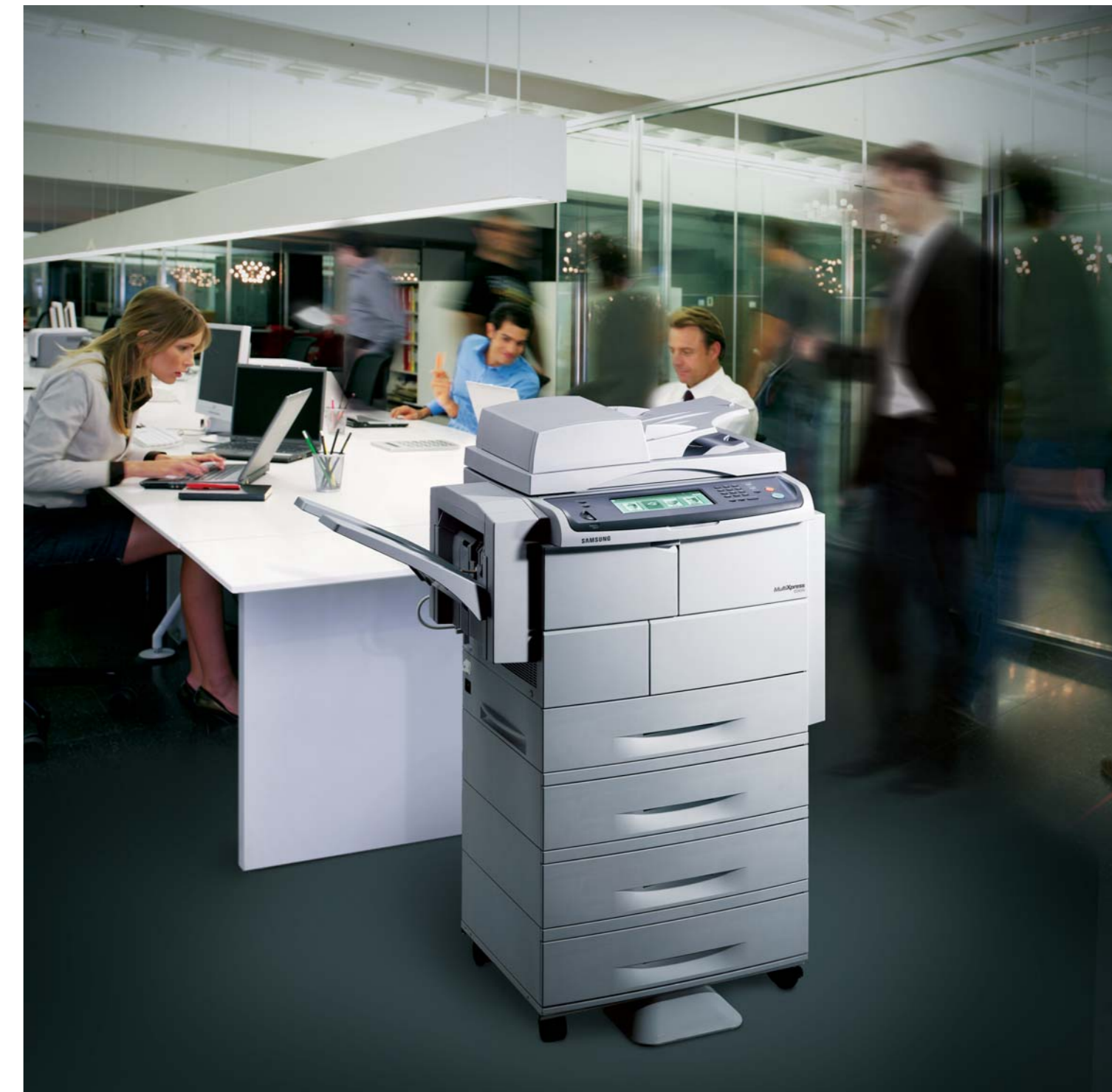

imagine an office solution capable of the highest workflow demands

Samsung **MultiXpress** 6345N





imagine an office solution capable of the highest workflow demands

Components



- Standard**
1. DADF (Duplex Automatic Document Feeder)
 2. Document width Guides
 3. Document Input Tray
 4. Document Output Tray
 5. Control Panel
 6. Scanner Lid
 7. Front Cover
 8. Multi-Purpose Tray
 9. Tray
 10. Drum
 11. Toner
 12. ADF Connector
 13. Output Support
 14. USB Port
 15. Network Port
 16. Stacker Connection
 17. Power Switch
 18. Power Receptacle
- Option**
20. Output Support : Finisher
 21. 22. 23. Optional Tray
 24. Short Stand
 25. Fax Kit

Control Panel Components



1. Machine Setup
2. Job Status
3. Screen brightness dial
4. Status
5. Screen
6. Number keypad
7. Clear
8. Redial/Pause
9. On Hook Dial
10. Power Saver
11. Interrupt
12. Clear All
13. Stop
14. Start

Why MultiXpress 6345N?

Because it is Effortless to Use

Wide Touch Screen/UI Design
Samsung's exclusive 640 x 240 wide LCD touch screen and 3-dimensional UI design can help users make selection simple and reduces time spent learning user manuals and educating new staff members.



Paper Handling

Additional paper trays can be added to provide up to 2,180 sheets of paper on line, reducing the need to frequently refill with paper. Also print job rescheduling manages the printing jobs based on FIFO (First In First Out) order. So when the previous printing job mismatches the property of the paper the next job can continue to print so reducing working time and running on the system.

to Install

Set, Consumables and Options

While general A3 copier takes up 3.5 hours to complete installation, it only takes approximately less than 30 minutes from unpacking the box to plug-in for the device to be ready to operate. With a modular build system it's easy to install consumables or upgrade options such as the finisher or memory as they can be simply slotted into the main device.

Customer Installable CRU Design



Interchangeable Second Trays

Expand online paper supply by adding 3 extra trays to give up to 2,180 sheets. Installation of the trays is simple and can be assembled in any sequence unlike some traditional copier devices.

to Maintain

Paper Jam

If and when a paper jam occurs the device indicates the problem area on the user display so you can simply, open the tray door to remove.

Automatic Toner Ordering System (i-ATOS)

This innovative automatic toner ordering system allows for easy and convenient ordering of supplies such as toner cartridges for your MFP. Once the i-ATOS application is installed, instant alerts to your designated supplier can be made by e-mail or a direct link to their homepage for ordering at the click of a button.

Because it is Effective to Use

Powerful Copier

Not only does the MultiXpress 6345N's produce 43 copies per minute in A4 size but its duplex copy speed is almost as fast ~ 40 copies per minute when using the in built Document Feeder[DADF]. Moreover, the MultiXpress 6345N performs nearly all the copy functions that are generally operated on A3 copiers.

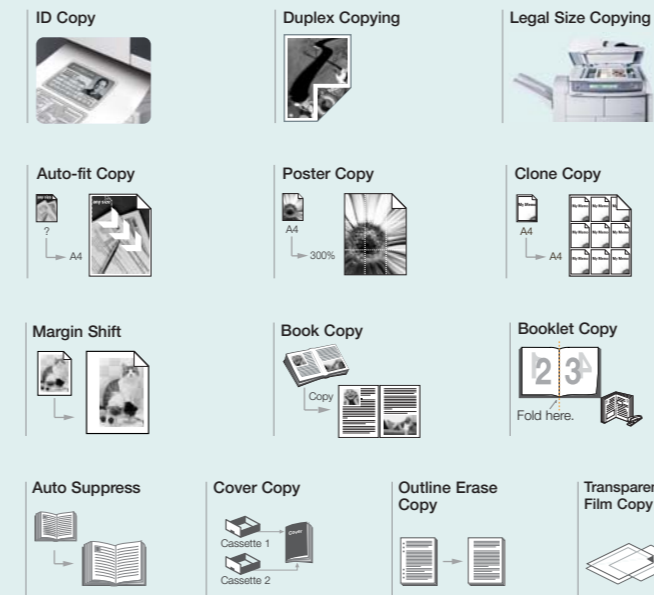

Powerful Printer

At 43 prints per minute (simplex) and 40 prints per minute (duplex) your workloads can be completed efficiently. And with many standard printing functions built in you can expand the range of your printing jobs.

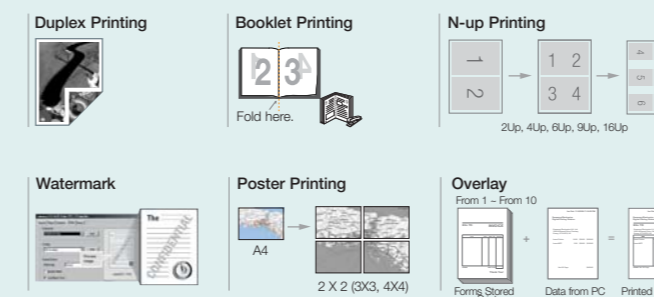

Vivid Colour Scanner & Network Scan

The MultiXpress 6345N's enhanced scanning resolution (4,800 x 4,800 dpi) and colour CCD method can help you deal with the finest quality for your document production.

Powerful Fax (Option)

With the optional Fax kit installed you can experience a variety of functions such as speed dial up to 200 numbers, group dial up to 100 groups (max. location per 1 group is 200), duplex send and receive, Fax-Email and etc. And because of the Duplex function then received faxes can be printed out double sided to reduce your operating costs.

Because it is Economical to Reduce

TCO (Total Cost of Ownership)

When compared to the TCO of general A3 office copiers the Samsung MultiXpress 6345N's TCO can result in one of the lowest running costs in its class at an average of 10,000 prints per month[AMPV].

TCO Comparison by AMPV

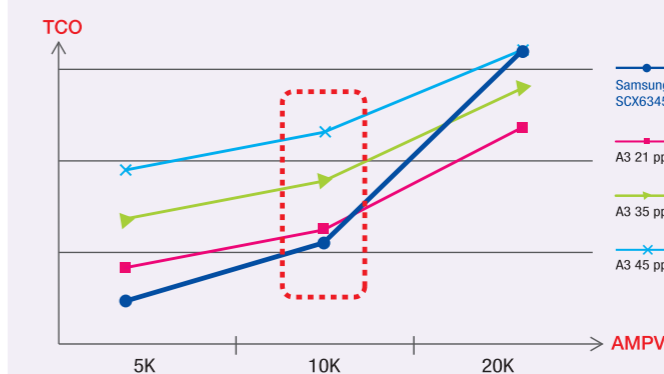

*Factor
 ① Set Price : based on the vendor's websites
 ② Consumable CPP ③ PM Parts CPP ④ Service Cost

Space

MultiXpress-6345N's economical design takes up to 75% less space in your office than general A3 copiers so you have more room around you.

Toner and Energy

With the embedded "Toner Save Mode" in the Printer driver, users can save toner by up to 25%. This is ideal for printing draft documents and reports without seeing a dramatic reduction in print quality.

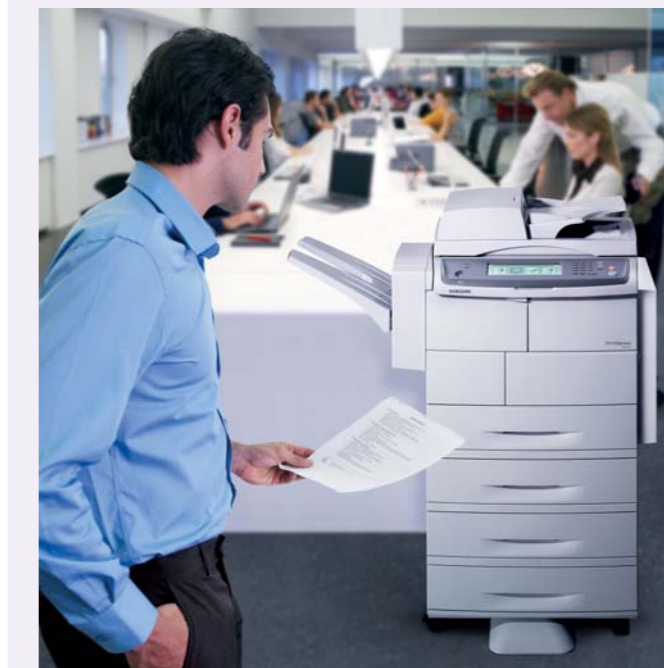

Because it is Enhanced to Manage

Expanded Printing

- Capabilities with Hard Disk Solution
 : An embedded 40GB HDD reduces network traffic congestion and saves computer storage space.

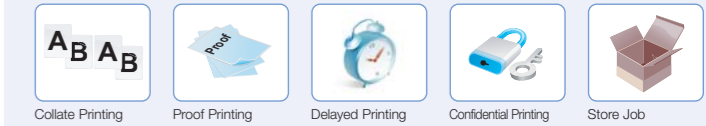

Scan to Anywhere

The MultiXpress 6345N supports efficient distribution of scanned documents by allowing you to send them through e-mail, FTP, SMB, Client.

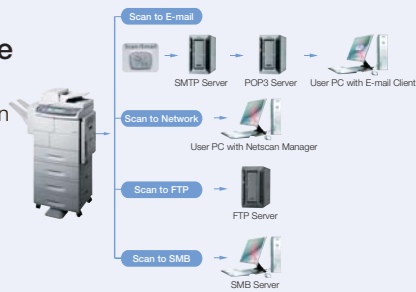

SyncThru™ Web Admin Service

SyncThru™ Web Admin service allows IT managers to easily manage and monitor all printers/MFPs on the network. The powerful feature permits job accounting, usage metering, authentication, storage management, remote driver installation and modification settings.

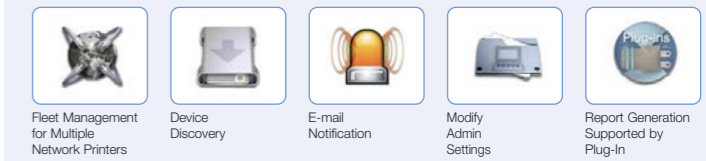

SyncThru™ Web Service

It provides administrators with the ability to change network and individual Printer settings, upgrade firmware and view network printer/MFP status.

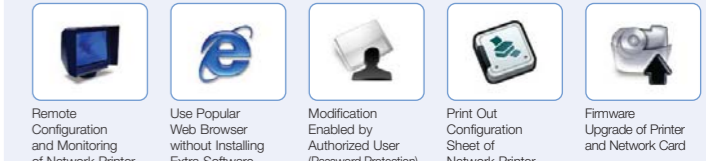

SmarThru™ Office

Document management and editing features are greatly enhanced for easy and convenient use with Samsung MFP in offices with complicated networks and a variety of equipment. Also network scan is provided as default.



SmarThru™ Workflow (Option)

SmarThru™ Workflow streamlines the document capture-process-route system enabling easy document management. This additional software is provided with the Samsung Network Scan Kit.